



**2/6-12 Pacific Street Manly NSW**

3 2 2

An outstanding opportunity and an exceptional lifestyle choice this sensational oversized garden apartment epitomises easy, comfortable and quality living.

Located in the well sort after Shearwater Apartments and on the flat where you can enjoy a level walk to the numerous Manly Shops, Cafes, Restaurants, Bars, Parks, and a 50 metre walk to the beach. Convenience & easy living at its best with Buses at your doorstep servicing the Northern Beaches Hospital, Warringah Mall & Manly Wharf.

This expansive apartment is the largest in the complex aside from the penthouses and comes with a generous 227m2 on title resembling house like proportions, 3 outdoor terrace spaces for entertaining and a double lock up garage with storage. Visitor parking & lift access to the

**Building Size** : 227 sqm  
**View** : <https://www.skylinerealestate.com.au/sale/nsw/northern-beaches/manly/residential/apartment/7243905>



**Damien Dwyer**  
**02 9452 3444**



Living Area : 150 Sqm  
 External Area : 53 Sqm  
 Total Area : 203 Sqm

The floor plan is not to scale; measurements are indicative and in metres. All features included in this 3D plan are for inspiration purposes only. This is not an exact replica of the property or the position of exterior elements. Plans should not be relied on. Interested parties should make and rely on their own enquiries.

Produced by **DIAKRIT**

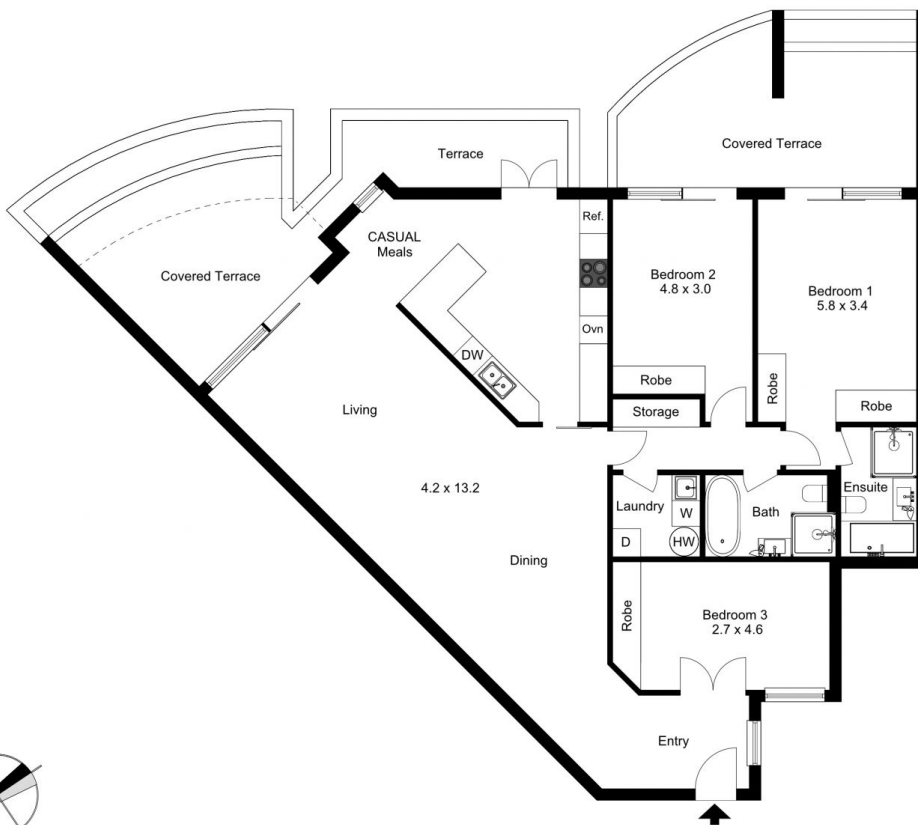

Living Area : 150 Sqm  
 External Area : 53 Sqm  
 Total Area : 203 Sqm

The floor plan is not to scale; measurements are indicative and in metres. Exterior elements are not in position. Plans should not be relied on. Interested parties should make and rely on their own enquiries.

Produced by **DIAKRIT**