



8 Cotswold Close Belrose NSW

4 2 3

Live a fantastic and easy going lifestyle as the new owners of this superb 4 bedroom family home. Our current owners certainly have and done so for the past 37 years. Enjoying the home and all the benefits living in this pocket of Belrose and child friendly cul de sac offers.

Generous with space and natural light which is further enhanced with high ceilings throughout, the home boasts multiple living, dining and entertaining zones perfect to meet the needs of a growing family. The versatile layout brings everyone together and gives everyone their own space with the kitchen like all good kitchens being the hub of the home.

North Easterly facing from the backyard and set on an expansive and level 833m2 block, this family haven is perfect for entertaining with the covered pergola, large

Price : \$ 2,295,000
Land Size : 833 sqm
View : <https://www.skylinerealestate.com.au/sale/nsw/northern-beaches/belrose/residential/home/7021440>



Damien Dwyer
02 9452 3444



Stuart Bath
02 9452 3444



The floor plan is not to scale; measurements are indicative and in metres. All features included in this 3D plan are for inspiration purposes only. This is not an exact replica of the property or the position of exterior elements. Plans should not be relied on. Interested parties should make and rely on their own enquiries.

Produced by **DIAKRIT**



The site plan and floor plan are not to scale; measurements are indicative and in metres. Bushes and trees are placed for illustration purposes. Plans should not be relied on. Interested parties should make and rely on their own enquiries.

Produced by **DIAKRIT**

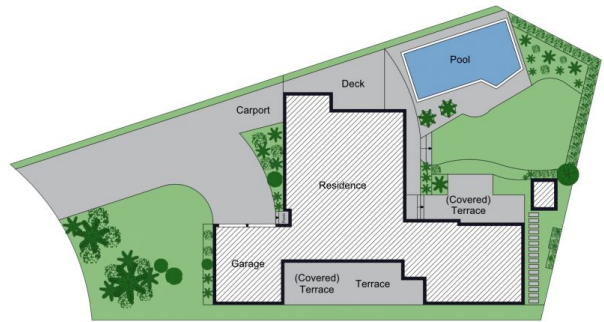

Site Plan