



2 Lynette Place Belrose NSW

4 3 2

Striking the perfect balance between lifestyle and modern living expectations, this lovely family home impresses over a 917sqm level block of land.

Beautifully presented interiors offer easy flowing integration from indoors to the amazing outdoor spaces and sun-drenched in-ground pool.

Its sought-after location is within close proximity to local Primary Schools, Glenrose Shopping Village and City buses.

Features include -

- ? Spacious open plan living areas flowing to the North-facing rear garden
- ? Four-bedrooms appointed with built-ins, main bedroom with ensuite
- ? The gourmet kitchen has stainless appliances, granite benches and generous cupboard space
- ? Large separate rumpus room which can be used as a

Price : \$ 1,866,000

Land Size : 917 sqm

View : <https://www.skylinerealestate.com.au/sale/nsw/northern-beaches/belrose/residential/home/5824339>



Stuart Bath
02 9452 3444

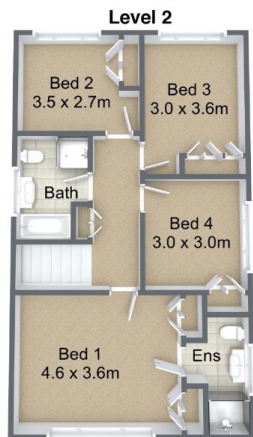

2 Lynette Place Belrose



This floor plan is generated for indicative purposes only. Information is provided in good faith from a variety of sources. Dimensions are approximate and although believed to be reliable, their accuracy cannot be guaranteed. Persons interested should rely on their own investigations.